

# FUNDRAISING TARGETS



## STORMWATER GREEN INFRASTRUCTURE

Asphalt removal, bioswales, trees, porous pavement, etc for stormwater management

**\$1,040,500**



## SCHOOL GARDENS & HEALTHY FOOD ACCESS

Raised garden beds, planting establishments

**\$5,000**



## RECREATIONAL IMPROVEMENTS

Gaga ball pits, limited asphalt repair, play structure installation

**\$235,000**



## OUTDOOR EDUCATIONAL ELEMENTS

Arts programming, musical and tactile elements, outdoor classroom features

**\$117,500**



## OTHER SITE IMPROVEMENTS

Bike parking equipment, schoolyard benches, pathways, fencing, storage shed

**\$112,500**

**TOTAL GOAL: \$1,510,500**

(includes \$90,500 in-kind est.)

We are actively pursuing funding for the schoolyard redevelopment, all levels of support are greatly appreciated.



Scan here to donate  
to Humboldt Park School

To learn more, download a copy of the full conceptual plan, or donate to the schoolyard redevelopment project, visit our website:

[www.RefloH2o.com](http://www.RefloH2o.com)

For more information, please contact:

**Erik Connor**

Principal - Humboldt Park School  
connrerer@milwaukee.k12.wi.us

**Ellie Salzwedel**

1st Grade Teacher - Humboldt Park School  
salzweem@milwaukee.k12.wi.us

**Lisa Neeb**

Green & Healthy Schools Program Manager - Reflo  
lisa.neeb@RefloH2o.com

In partnership with:

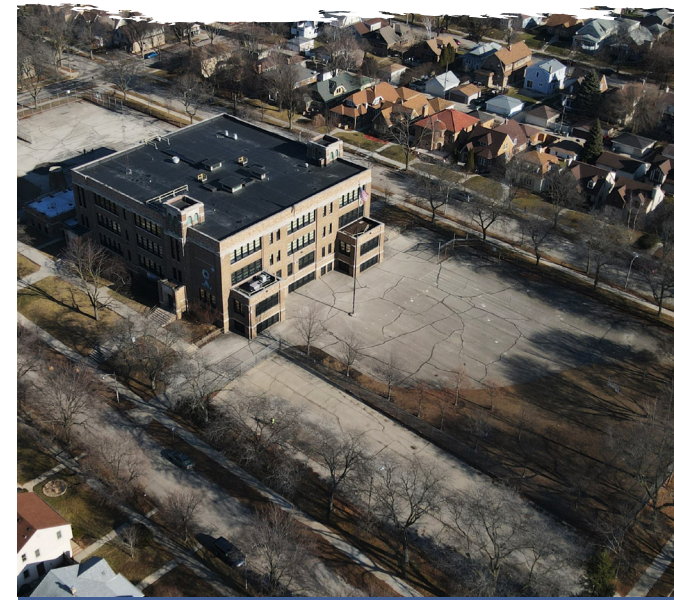

## Humboldt Park School

Conceptual Schoolyard  
Redevelopment Plan

Summary Brochure





Download the full conceptual plan document to learn more.

# Humboldt Park School Conceptual Plan

Fundraising through 2024  
Construction in 2025



## STORMWATER GREEN INFRASTRUCTURE

Green infrastructure including bioswales, native plantings, and a synthetic turf field with an underground cistern beneath it will help to better manage stormwater on the school grounds, where it falls, improving the aesthetics, biodiversity, recreational facilities, and the health of local watershed.

## OUTDOOR CLASSROOMS

To help facilitate ecoliteracy and all of the sensory exploration that comes with outdoor learning, Humboldt Park would like to enhance their current outdoor learning spaces and build two additional outdoor classrooms, completed with seating options.



S ADAMS AVE

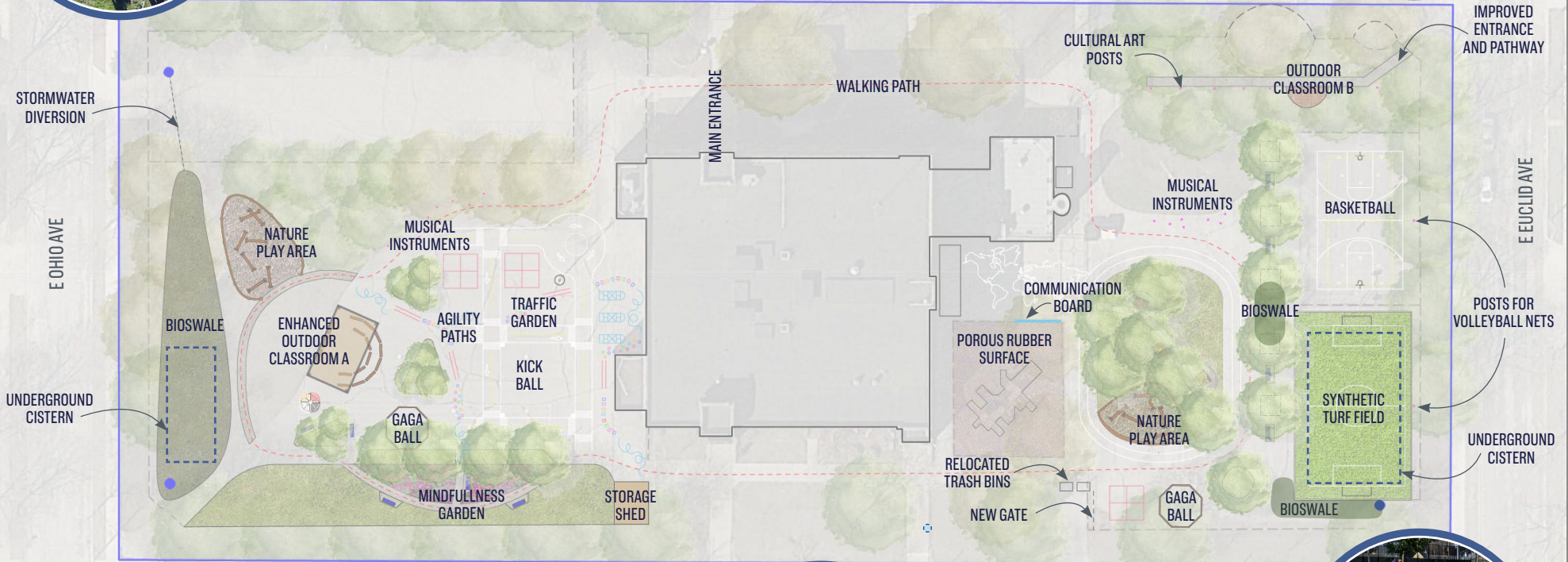

## MULTIPLE ARTS OPPORTUNITIES

There are many opportunities to include artistic elements throughout the schoolyard including art posts, murals, and educational signage to support the redevelopment project. The outdoor classrooms will also provide a setting for the performing arts.

## NATURE PLAY ELEMENTS

Humboldt Park School would like to incorporate natural playscape elements that nurture childhood creativity, foster wonder and imagination, and inspire healthy risk-taking.



## ADDITIONAL GREEN SPACE & RECREATIONAL IMPROVEMENTS

Reducing the amount of asphalt on the school grounds is a central component of the redevelopment plan. Along with new green space, earthen mounds, and tree plantings, Humboldt Park would like to add a synthetic turf soccer field, colorful pavement markings, and gaga ball pits to support physical activity, team building, and cooperative play.



S QUINCY AVE



0 25' 50' 100'

APPROXIMATE SCALE IN FEET